



GDX Next Video Handsets

Quick Start Guide v1.0

December 2025

p/n:	HSV	GDX Next Video Handset
	HFV	GDX Next Hands Free Apartment Station

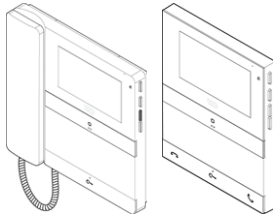

Technical Documentation



Doc ref: GDX_HV_QSG_v1

Disclaimer
COMELIT-PAC Ltd. does not assume any responsibility for:

- Any purpose other than the intended use.
- Failure to observe the indications and warnings contained in this manual / instruction sheet.

COMELIT-PAC Ltd. reserves the right to change the information provided in this manual at any time and without prior notice.



Item received will depend on product ordered.

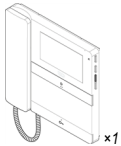

HSV GDX Next Video Handset

OR



HFV GDX Next Hands Free Video Apartment Station

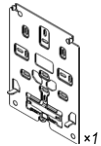

All GDX Next Video models

1.0 Installation

Wiring distances

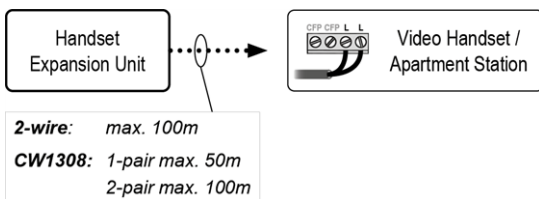

These distances apply to both Audio and Video Handsets

Health & Safety



Failure to follow installation instructions may increase the risk of injury or death by electric shock, and may cause damage to hardware.

Intended use

This product is designed and manufactured for use in the creation of audio and video communication systems in residential and public buildings.

Installation and Safe usage

COMELIT-PAC products must be installed to:

- Meet the requirements of the country of installation's National Wiring Regulations (BS7671, IET National Wiring Regulations in the UK) and EN60950-1.
- Be carried out by suitably competent, qualified and experienced personnel.
- Comply with any local fire, health and safety regulations.
- Ensure hardware and controllers (e.g. entrance panels, readers, door controllers, etc.) are earthed.

Cabling

Control systems' cabling should be installed to reduce interference with other equipment and / or building environment.

- Do not run system cables alongside any heavy load switching cables.
- When you must run close to HV cables cross the cable at right angles every 1–2 m / 3–6 ft.
- To ensure safety, compliance, and ease of maintenance, we strongly recommend that all Extra Low Voltage (ELV) cabling be installed using dedicated sectioned cable trays or protective tubing.

For new installations

- Communication connections 2-wire 0.5mm².
- Retrofit communication connections CW1308 1-pair or 2-pair.
- 4-core unscreened (2-wire 0.5mm² (gnd) + 2-wire 0.22mm²)

For retrofit options



For existing cabling, use cables with a cross-section suited to the current requirements and distances involved for data connections.

Maintenance

- Any damaged or faulty products must be reported to COMELIT-PAC Technical Support.
- Any attempt to carry out repairs or modification to the electronic components or the physical product will void the product warranty.
- Do not use alcohol or aggressive products for cleaning purposes.

Equipment Electrical Rating

All electrical equipment should have electrical ratings clearly stated on an identification label and in any documentation provided. Any applicable fuse ratings will also be specified within the documentation.

WEEE Directive and Product Disposal



At the end of its serviceable life this product should not be treated as household or general waste. It should be handed over to the applicable collection point for the recycling of electrical and electronic equipment or returned to the supplier for disposal.

2

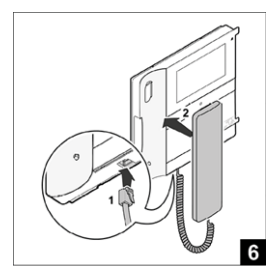
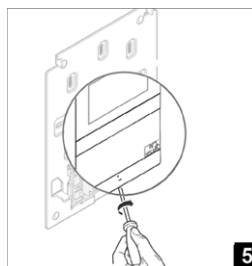
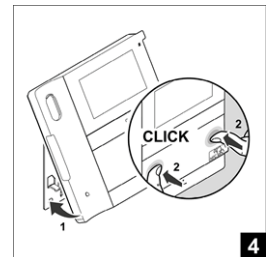
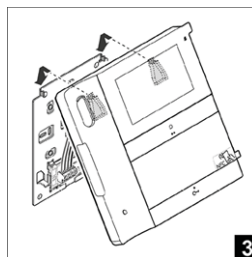
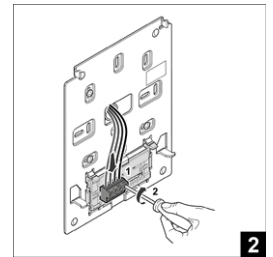
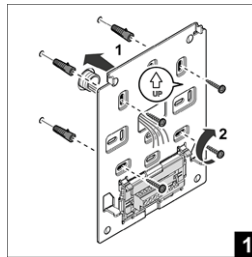

3

4

2.0 Handset Overview

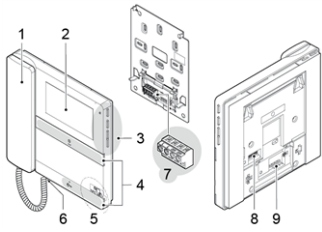

1. Handset
2. 4.3" LCD screen
3. Mechanical side buttons
4. Mechanical front buttons, with touch guides for sight impaired users.
5. NFC detection area with a removable sticker.
6. Handset connector.
7. Connection terminals: L L Terminals for 2-wire connections
8. Dip-switch for Handset Address.
9. Pin to secure terminal block.

3.0 Hands Free Overview

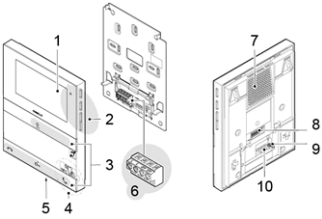

1. 4.3" LCD screen.
2. Mechanical side buttons.
3. Mechanical front buttons, with touch guides for sight impaired users.
4. NFC detection area with a removable sticker.
5. Microphone.
6. Connection terminals: L L Terminals for 2-wire connections.
7. Speaker.
8. Dip-switch for Handset Address.
9. Not used.
10. Pin to secure terminal block.

4.0 Handset Addressing

The Handset Address can be amended via the **dip-switches** or by using the **MyComelit app**.

Manual Addressing

To set the address of the handset.

- Push up for ON.
- Push down for OFF.

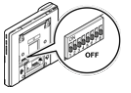

The switches are all set to OFF in the example opposite.

Address table	Binary value
17 1,5	1 2 4 8 16 32 64
18 3,5	ON OFF OFF OFF OFF OFF OFF
19 12,5	Dipswitch # 1 2 3 4 5 6 7 8
20 3,5	
21 13,5	

Handset address = 19

Add binary values of switches: 1 + 2 + 16 = 19

5.0 Using MyComelit App

Please download **myComelitApp** from Apple App Store or Google Play.

- The Video Handsets have an NFC connection and can be programmed quickly via the myComelit app, which is available to download free of charge.
- Handset Addressing can also be performed when the Video Handset is powered off.
- The Handset Address for several door entry monitors can be programmed in sequence.

A Handset Address must be assigned to enable the call to be routed to the correct apartment.

Ensure all dip-switches are set to OFF before using the myComelit app.

Table of Handset Address codes

5

Addr	Switch
1	1
2	2
3	12
4	3
5	13
6	23
7	123
8	4
9	14
10	24
11	124
12	34
13	134
14	234
15	1234
16	5
17	15
18	25
19	125
20	35
21	21
22	135
23	235
24	1235
25	23
26	45
27	25
28	145
29	245
30	1245
31	345
32	26
33	145
34	245
35	12345
36	46
37	25
38	1456
39	2456
40	123456
41	146
42	246
43	1246
44	346
45	1346
46	2346
47	12346
48	56
49	156
50	256
51	1256
52	356
53	1356
54	2356
55	12356
56	456
57	1456
58	2456
59	12456
60	3456
61	146
62	246
63	1246
64	346
65	1346
66	2346
67	12346
68	37
69	137
70	237
71	1237
72	47
73	147
74	247
75	1247
76	347
77	1347
78	2347
79	12347
80	57
81	13456
82	23456
83	123456
84	357
85	1357
86	2357
87	12357
88	457
89	1457
90	2457
91	12457
92	3457
93	13457
94	23457
95	123457
96	67



For more address codes please see the Full Installation Manual via the QR code



* Code 240 is reserved for Concierge if available.

6

6.0 Privacy Function



The Privacy button will toggle Manual Privacy mode ON / OFF. It will remain active until manually disabled by the resident.

Manual Privacy Mode

1. Press the Privacy button ONCE to silence the handset ringtone.
2. Privacy mode will stay ON until it is manually disabled.
3. Press the Privacy button ONCE to disable.

Timed Privacy Mode



Timed Privacy Mode cannot be used if there is an active call.

This mode enables the resident to temporarily apply a Privacy period from 2-hours, 4-hours, 8-hours or 12-hours.

Follow the instructions below to select a time period:

1. Press AND HOLD the Privacy button for over 1-second.
 - The red LED will flash twice a second.
 - 1× short beep indicates the 2-hour duration has been selected.
2. Each subsequent press of the Privacy button will select the next time period:

Press Privacy button ×2	2× short beeps sets 4-hour duration
Press Privacy button ×3	3× short beeps sets 8-hour duration
Press Privacy button ×4 (max.)	4× short beeps sets 12-hour duration
Press Privacy button > ×4	The time period is reset and 1× short beep sets 2-hour duration
3. To Exit Timed Privacy Mode:
 - Wait for 5-seconds and Privacy will be set to the selected time period.

Technical Support

pacgdxsupport@comelit-pac.co.uk

T: +44 (0)1707 377203

Training

trainingacademy@comelit-pac.co.uk

T: +44 (0)1707 377203



Technical Documentation



7